

Commonwealth Youth Games Road Closures and Traffic Regulation Orders

The Department of Infrastructure gives notice that the following Orders will be made in relation to the Commonwealth Youth Games:

Thursday 8 September 2011 – Opening Ceremony

- (1) Under Section 3 of the Road Traffic Regulation Act 1985 the following roads will have a temporary prohibition of waiting between **5.00 pm** and **10.30 pm**.
 - (i) Both sides of Pulrose Road, Douglas from its junction with Peel Road to its junction with Groves Road.
 - (ii) The whole of Groves Road from Pulrose Road to its junction with the New Castletown Road.

Friday 9 September 2011 – Douglas Cycle Races

- (1) Under Section 3 of the Road Traffic Regulation Act 1985 the following roads will have a temporary suspension of parking places between **5.00 pm** and **10.30 pm**.
 - (i) King Edward Road, Onchan from a point opposite the eastern boundary of the property known as Terminus Tavern for a distance of 128m, other than stage service vehicles.
- (2) Under Section 3 of the Road Traffic Regulation Act 1985 the following roads will have prohibition of waiting orders effective between **5.00 pm** and **10.30 pm**.
 - (i) King Edward Road, Onchan from a point 128m beyond the eastern boundary of the property known as the Terminus Tavern to its junction with but not including Harbour Road.
 - (ii) Sea Cliff Road from its southern junction with King Edward Road to its northern junction with King Edward Road.
 - (iii) A 38 link road between Summerhill Road, Douglas and King Edward Road.
- (3) Under Section 38 of the Highways Act 1986, the following roads in Douglas and Onchan (The Course) will be closed to all traffic including pedestrians (other than certain authorised traffic) between **6.00 pm** and **10.30 pm** for cycle racing.
 - (i) The entire length of the Promenade Walkway, Douglas including the cycleway.
 - (ii) King Edward Road from a point 30m from the existing bus stop opposite the Terminus Tavern to its junction with but not including Harbour Road.
 - (iii) Sea Cliff Road from its southern junction with King Edward Road to its northern junction with King Edward Road.

Saturday 10 September 2011 – Douglas Cycle Races

- (1) Under Section 38 of the Highways Act 1986, the following roads in Douglas and Onchan (The Course) will be closed to all VEHICULAR traffic (other than certain authorised traffic) between **9.45 am** and **4.30 pm** for cycle racing.
 - (i) **Park Avenue** from its junction with Glencrutchery Road to its junction with Ballanard Road. Access will be maintained from St George's Bridge to Lanjaghan Road.
 - (ii) **Ballanard Road** from its junction with Park Avenue to its junction with Scholague Road.
 - (iii) **Scholague Road** from its junction with Ballanard Road to its junction with Johnny

- Watterson's Lane.
- (iv) **Johnny Watterson's Lane** from its junction with Scholague Road to its junction with the A18 Mountain Road.
 - (v) **A18 Mountain Road** from its junction with Johnny Watterson's Lane to its junction with Glencrutchery Road using Governors Bridge Dip. Access will be maintained from Governors Road to Victoria Road.
 - (vi) **Glencrutchery Road** from Governors Bridge to its junction with Park Avenue.

Pedestrian Access during cycle races

Pedestrians may only cross the course during the cycle races with the permission of a marshal.

Opening of the course between cycle races

The whole of the course will be open to vehicles and pedestrians from 12.15pm to 1.00pm.

Sunday 11 September 2011 Douglas Cycle Races

- (1) Under Section 38 of the Highways Act 1986, the following roads in Douglas (The Course) will be closed to all VEHICULAR traffic (other than certain authorised traffic) between **12.15 pm** and **6.15 pm**:
 - (i) Broadway from its junction with Victoria Road to its junction with Harris Promenade.
 - (ii) Harris Promenade from its junction with Broadway to the right turn junction opposite the Gaiety Theatre.
- (2) Under Section 3 of the Road Traffic Regulation Act 1985 the taxi ranks and motorcycle parking bay shall be suspended on sections of Loch Promenade and Harris Promenade, Douglas between **12.15 pm** and **6.15 pm**:
- (3) Under Section 3 of the Road Traffic Regulation Act 1985 the loading bay shall be suspended on Harris Promenade, Douglas between **12.15 pm** and **6.15 pm**:
- (4) Under Section 3 of the Road Traffic Regulation Act 1985 parking shall be suspended on the following roads between **12.15 pm** and **6.15 pm**:
 - (i) Broadway from its junction with Victoria Road to its junction with Harris Promenade.
 - (ii) Harris Promenade from its junction with Broadway to the right turn junction opposite the Gaiety Theatre.
 - (iii) Central Promenade from a point 26 metres north east of its junction with the E26 Unnamed Lane between Clarence Terrace and the Esplanade in a north easterly direction for a distance of 26 metres.
 - (iv) Finch Road from its junction with Mount Havelock to its junction with Prospect Hill.

Monday 12 September 2011 – Castletown Day

- (1) Under Section 38 of the Highways Act 1986, the following roads in Castletown will be closed to all VEHICULAR traffic (other than certain authorised traffic):
 - (i) Castle Quay from its junction with Bank Street to its junction with Castle Street between **9.30 am** and **4.30 pm**.
 - (ii) Castle Street from its junction with Castle Quay to its junction with The Parade between **9.30 am** and **4.30 pm**.
 - (iii) The Parade from its junction with Castle Street to its junction with Queen Street between **9.30 am** and **4.30 pm**.
 - (iv) Queen Street from its junction with The Parade to its junction with Farrant Way between **9.30 am** and **4.30 pm**.
 - (v) Market Square from its junction with Castle Street to its junctions with Malew Street and Arbory Street between **9.30 am** and **4.30 pm**.
 - (vi) Bridge Street from the property numbered 10 Bridge Street to its junction with East Quay between **12.15 pm** and **1.45 pm**.

- (vii) The whole of East Quay between **12.15 pm and 1.45 pm.**
 - (viii) Thirtle Bridge across Castletown Harbour to its junction with Castle Quay between **12.15 pm and 1.45 pm.**
 - (ix) Castle Quay from Thirtle Bridge to its junction with Bank Street between **12.15 pm and 1.45 pm.**
- (2) Under Section 3 of the Road Traffic Regulation Act 1985 parking shall be suspended on the following roads:
- (i) Market Square both sides between **8.30 am and 4.30 pm.**
 - (ii) The Parade from its junction with Castle Street to its junction with Queen Street between **8.30 am and 4.30 pm.**
 - (iii) Bridge Street both sides between **12.15 pm and 1.45 pm.**

Closing Ceremony and Fireworks Display, Douglas

- (1) Under Section 38 of the Highways Act 1986, the following roads in Douglas will be closed to all VEHICULAR traffic (other than certain authorised traffic) between **10.15 pm and 11.15 pm:**
- (i) Harris Promenade from its junction with Broadway to the right turn junction opposite the Gaiety Theatre.
 - (ii) Promenade Walkway and Cycleway will be closed to pedestrian and vehicular traffic from the end of the sunken gardens to Broadway as delineated by barriers between **6.00 pm and 11.15 pm.**
- (2) Under Section 3 of the Road Traffic Regulation Act 1985 the taxi ranks shall be suspended on Harris Promenade, Douglas between **7.30 pm until 8.00 pm and 9.15 pm and 11.15 pm.**
- (3) Under Section 3 of the Road Traffic Regulation Act 1985 the loading bay shall be suspended on Harris Promenade, Douglas between **7.30 pm until 8.00 pm and 9.15 pm and 11.15 pm.**
- (4) Under Section 3 of the Road Traffic Regulation Act 1985 parking shall be suspended on the following roads between **9.15 pm and 11.15 pm:**
- (i) Harris Promenade from its junction with Broadway to the right turn junction opposite the Gaiety Theatre.

Access will be maintained from Broadway to Central Promenade.

During cycle races diversion routes will be signed.

In the event of any queries a helpline is available on **308008.**

In the event of adverse weather conditions or any other exceptional circumstances, these Orders may be postponed until the following day.

Copies of the Orders may be inspected at any Police Station or at the Department's offices. Offences against the Orders may render the offender liable to a penalty not exceeding £2500.

This notice gives general guidance only, and should not be treated as an authoritative statement of the law.

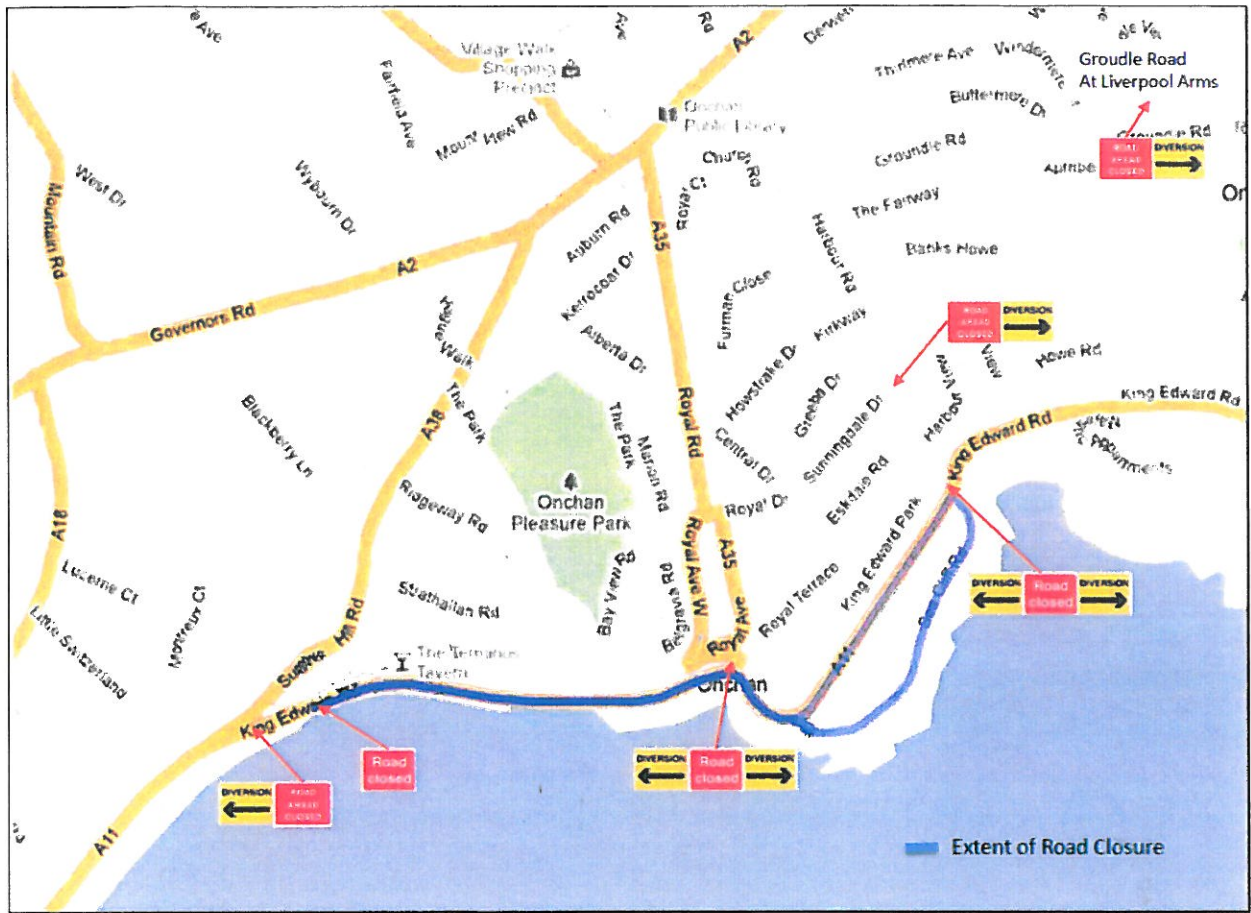

**IV COMMONWEALTH
YOUTH GAMES**
**Road Closure Order
Map**
DOUGLAS - CRITERIUM

Legend
 Cycle Races: Criterium

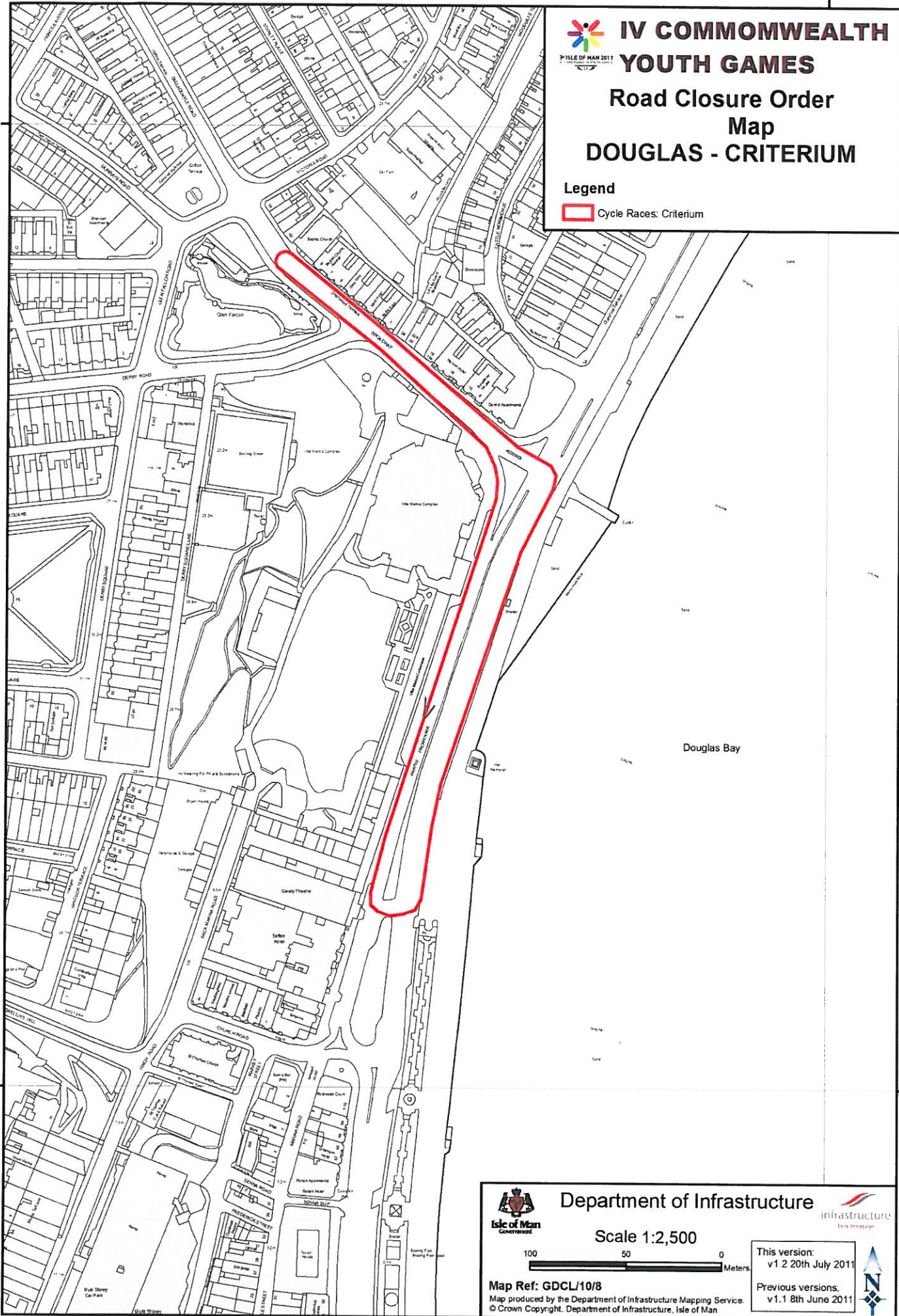

Department of Infrastructure 

Scale 1:2,500

100 50 0 Meters

Map Ref: GDCL/10/8
 Map produced by the Department of Infrastructure Mapping Service.
 © Crown Copyright. Department of Infrastructure, Isle of Man

This version:
v1.2 20th July 2011

Previous versions:
v1.1 8th June 2011



237000

237500

238000

238500

239000

480000

479500

479000

478500

478000

477500

477000

480000

479500

479000

478500

478000

477500

477000



IV COMMONWEALTH YOUTH GAMES

Road Closure Order Map

DOUGLAS - ROAD RACE

Legend

Cycle Races: Road Race

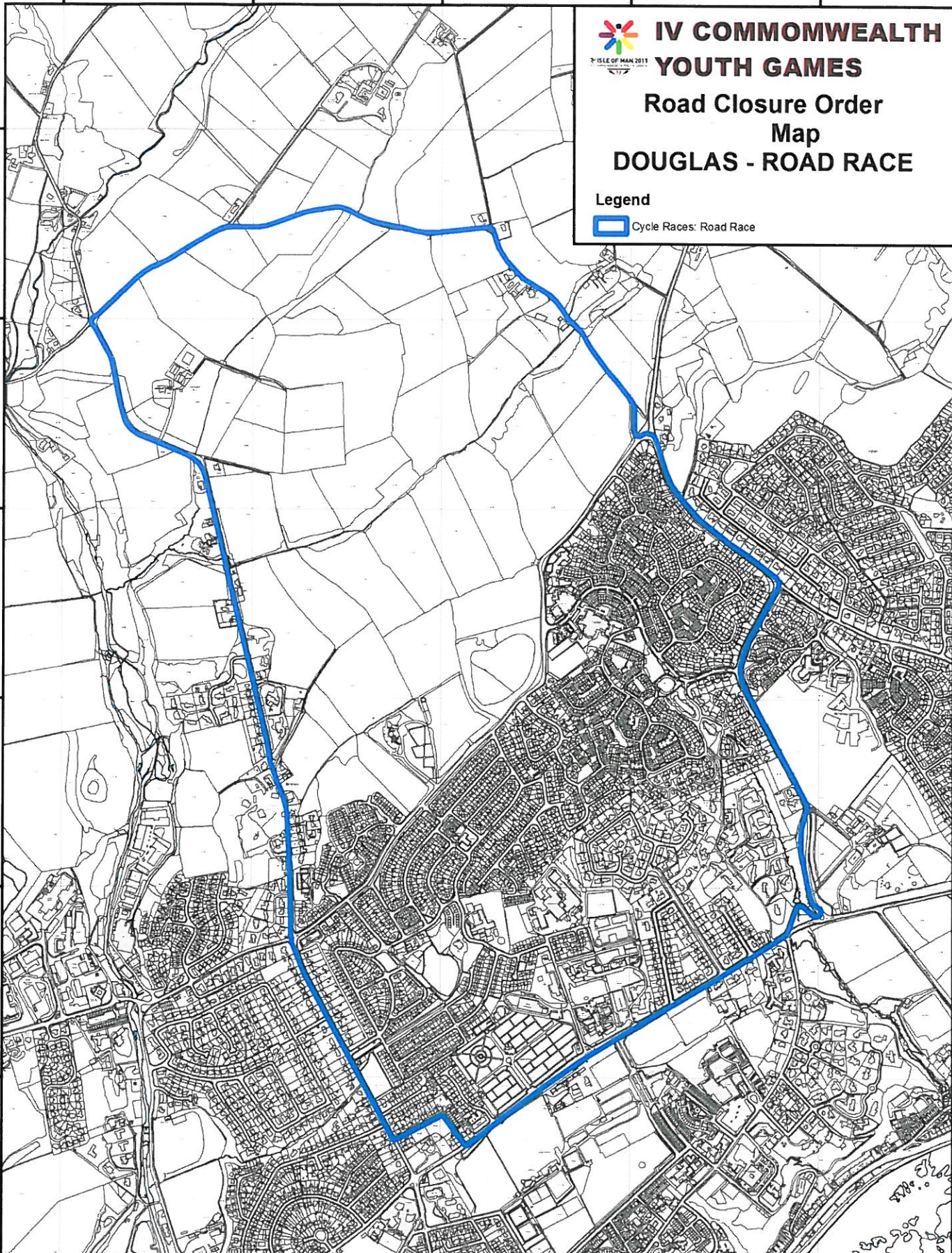

Department of Infrastructure



Scale 1:13,500



Map Ref: GDCL/10/8

Map produced by the Department of Infrastructure Mapping Service.
© Crown Copyright. Department of Infrastructure, Isle of Man.

This version:
v1.2 20th July 2011

Previous versions:
v1.1 8th June 2011



237000

237500

238000

238500

239000